

GSM-Kamera GSM03

Overview

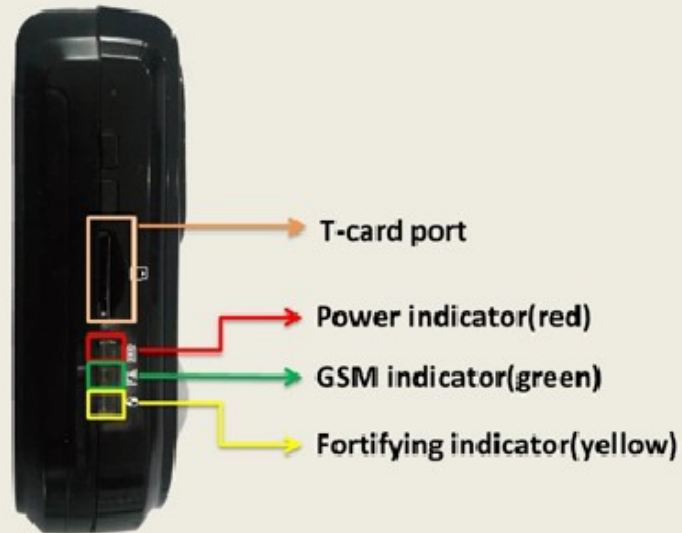

Overview

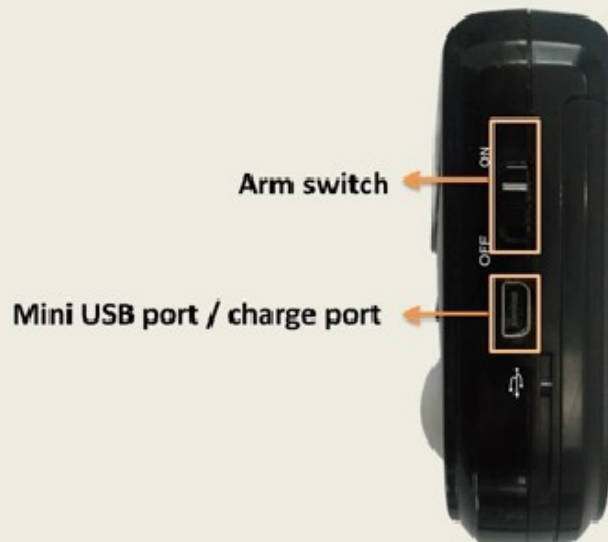

Overview



Overview

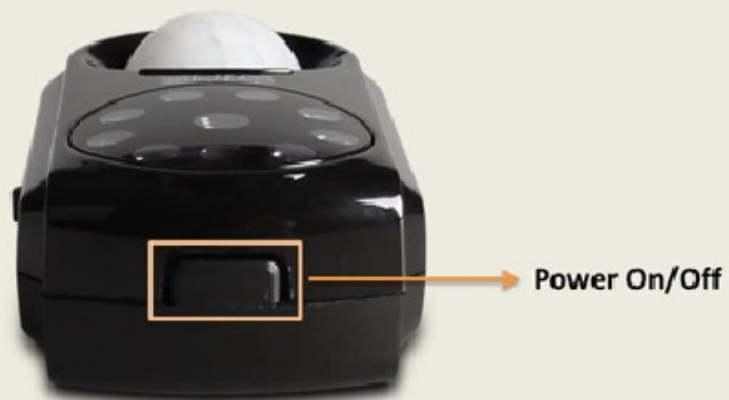

Overview



Remove the back cover

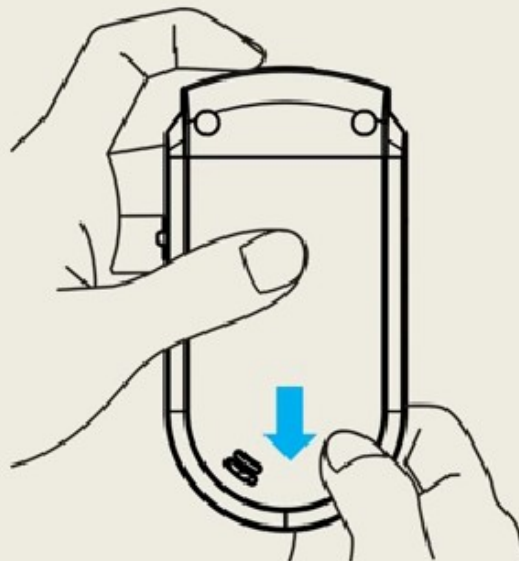

Install the battery

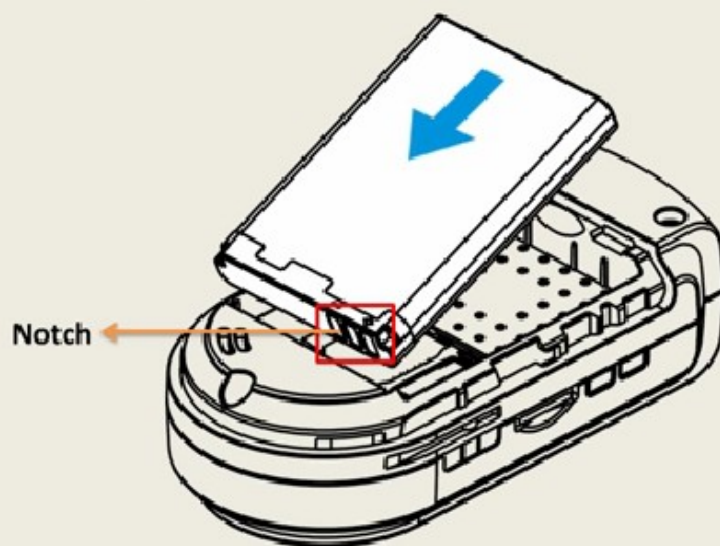

Put it on a solid platform and make sure the camera aim to the right direction.

Connect to AC power.



Setting

Above all : There is **NO blank** in any command.

Step 1: Set SOS number

Send **SOS,A,phone number1,phone number2,phone number3#** to add SOS numbers

Example: **SOS,A,80686666,80685555,8068888#**

Step 2: Set APN & MMS

*Kindly get the APN and MMS related info from your carrier, make sure if you need User name and Password to set APN & MMS or not.

Step 2: Set APN & MMS

*Kindly get the APN and MMS related info from your carrier, make sure if you need User name and Password to set APN & MMS or not.

GPRS DATA

APN: **kktcell**

Username: Blank

Password: Blank

MMS DATA

APN: **mms.kktcell**

Username: Blank

Password: Blank

MMSC:

<http://mms.kktcell.com/cmmmc/post>

MMS Proxy: **212.252.169.99**

MMS Port: **8080**

A. If your APN is without User Name and Password, send

APN, apnname#

for example apn,kktcell#

to set APN.

If your APN has User Name and Password to set it, send

APN,apnname,user,pwd#

for example

apn,orange,orange,orange#

to set APN.

B. If you can set MMS without User Name and Password,
send MMS,url,IP,port,APN#

for example

mms,http://mms.kktcell.com/cmmssc
/post,212.252.169.99,8080,mms.kkt
cell#

to set MMS.

Step 3: Confirm the APN & MMS setting

Send **GPRSSET#** to
check the APN & MMS
setting are right.

You will receive a SMS like this:

GPRS APN: **kktcell**
GPRS name:Blank
GPRS pwd:Blank
MMS
URL:<http://mms.kktcell.com/cmmsc/post>
MMS IP: **212.252.169.99**
MMS port:**8080**
MMS APN: **mms.kktcell**
MMS name:Blank
MMS pwd:Blank
MMS type:Blank

Step 4: Activate system and test

- A. Send **MMSON#** to activate the MMS alert function.
- B. Send **PHOTO#** or **333** to test if the camera can send snapshot with MMS message.
- C. Send **ON#** or slide the arm switcher to arm the system.
SMS **Alarm fortification success!** will be sent to SOS number.
- D. Motion activated.

Now your GM01 is basically set up!

If you need Dialing Notification,

Send **CALLSET,call time#** to set Dialing Notification.

Call Time is between 0-3, 0 means off dialing notification.

For example **CALLSET,3#**

You will receive a SMS as **Set Success!** in one minute.